

# Return rollers

Example of application

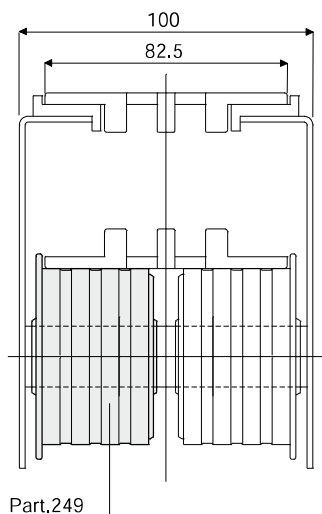

Example of application

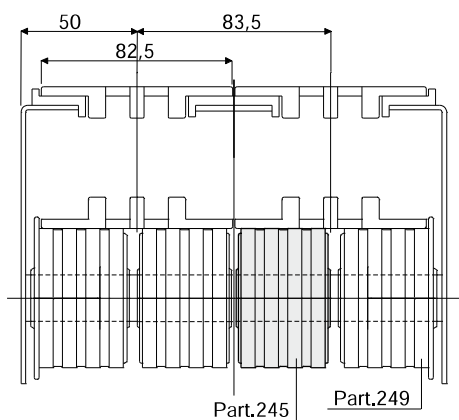

Example of application

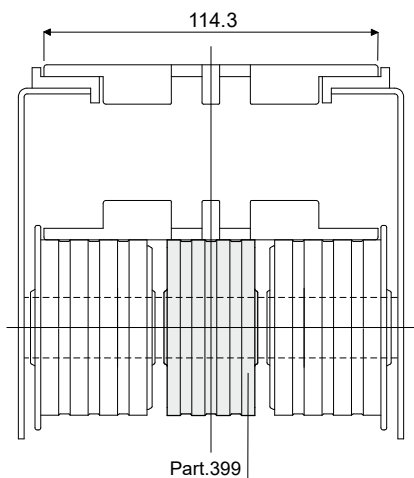

## Roller with rubber for chain return (with flange)

Part. **249**

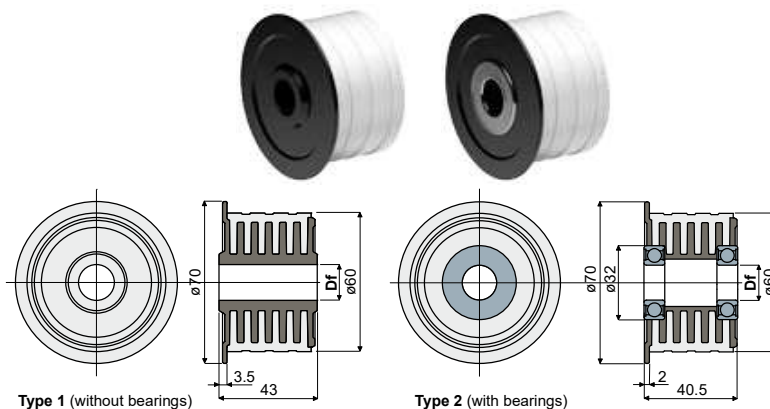

Df Bore for pin of (mm)	Type 1 (without bearings) Code	Type 2 (with bearings) Code	Bearing type
15	249 / 82021	249 / 83642	6002-ZZ
16	249 / 82022	-	-
18	249 / 82023	-	-
20	249 / 82024	-	-

**MATERIALS:** Internal part is made of polyamide black colour; external rubber is made of thermoplastic rubber grey colour 65 Shore; bearing made of chrome steel.

**FEATURES:** This roller is completely closed, total lack of internal cavities to obtain the maximum level of cleanability and noiselessness during working operations.

**BOX QUANTITY:** 48 pieces.

**ON REQUEST:**

- Rollers: Special bores, other colours.
- Box Quantity: According to your request.

## Roller with rubber for chain return (without flange)

Part. **245**

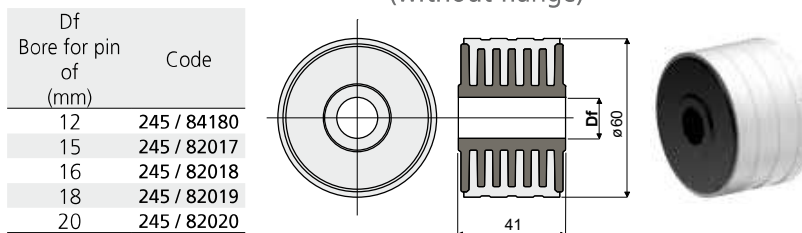

**MATERIALS:** Internal part is made of polyamide black colour; external rubber is made of thermoplastic rubber grey colour 65 Shore.

**FEATURES:** This roller is completely closed, total lack of internal cavities to obtain the maximum level of cleanability and noiselessness during working operations.

**BOX QUANTITY:** 48 pieces.

**ON REQUEST:**

- Rollers: Special bores, other colours.
- Box Quantity: According to your request.

## Roller with rubber for chain return (without flange)

Part. **399**

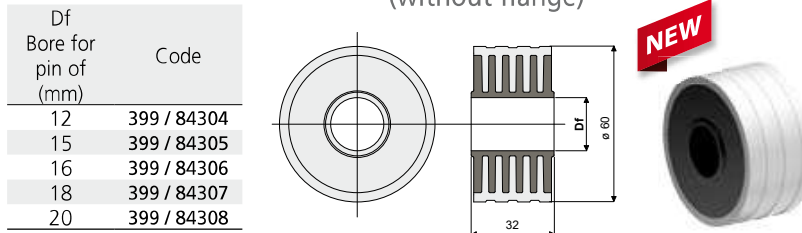

**MATERIALS:** Internal part is made of polyamide black colour; external rubber is made of thermoplastic rubber grey colour 65 Shore.

**FEATURES:** This roller is completely closed, total lack of internal cavities to obtain the maximum level of cleanability and noiselessness during working operations.

**BOX QUANTITY:** 48 pieces.

**ON REQUEST:**

- Rollers: Special bores, other colours.
- Box Quantity: According to your request.

# Return rollers

## Part. 293 Roller with rubber for chain return (without flange)

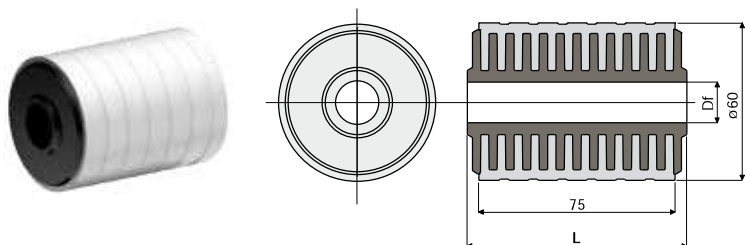

Df Bore for pin of (mm)	L = 82 mm	L = 84 mm
	Code	Code
12	293 / 82789	293 / 82833
15	293 / 82580	293 / 82581
16	293 / 82582	293 / 82583
18	293 / 82584	293 / 82585
20	293 / 82586	293 / 82587

**MATERIALS:** Internal part is made of polyamide black colour; external rubber is made of thermoplastic rubber grey colour 65 Shore.

**FEATURES:** This roller is completely closed, total lack of internal cavities to obtain the maximum level of cleanability and noiselessness during working operations.

**BOX QUANTITY:** 48 pieces.

**ON REQUEST:**

- Rollers: Special bores, other colours.
- Box Quantity: According to your request.

### Example of application

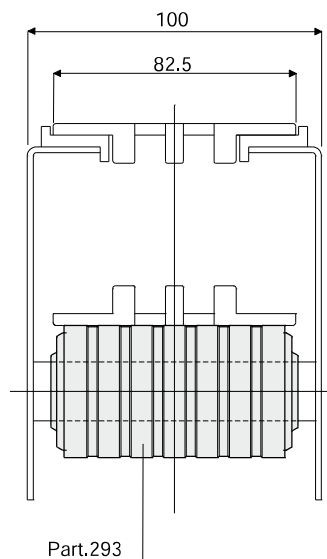

## Part. 276 Roller with rubber for chain return (without flange)

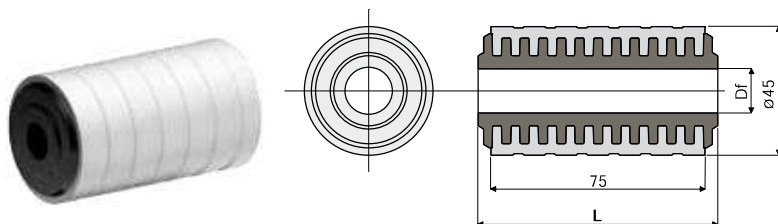

Df Bore for pin of (mm)	L = 82 mm	L = 84 mm
	Code	Code
12	276 / 82853	276 / 82855
15	276 / 82060	276 / 82061
16	276 / 82062	276 / 82063
18	276 / 82064	276 / 82065
20	276 / 82066	276 / 82067

**MATERIALS:** Internal part is made of polyamide black colour; external rubber is made of thermoplastic rubber grey colour 65 Shore.

**FEATURES:** This roller is completely closed, total lack of internal cavities to obtain the maximum level of cleanability and noiselessness during working operations.

**BOX QUANTITY:** 48 pieces.

**ON REQUEST:**

- Rollers: Special bores, other colours.
- Box Quantity: According to your request.

### Example of application

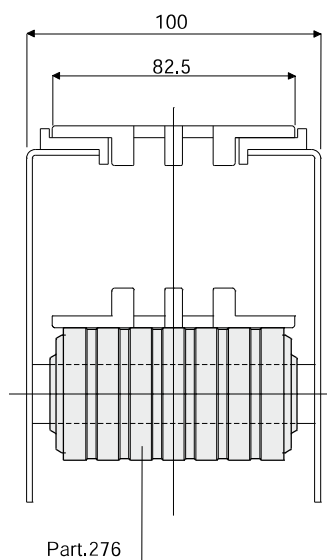

# Return rollers

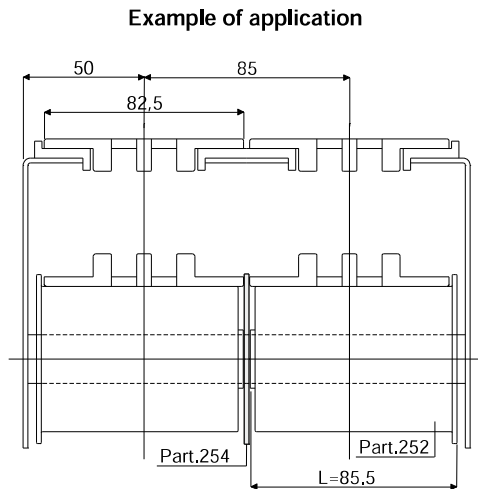

## Flange for chain guide (for roller Part. 251, 252, 253, 245, 293, 250, 249)

Part. **254**

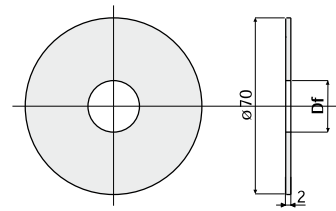

Df Bore for pin of (mm)	Code
12	254 / 82630
14	254 / 82264
15	254 / 82251
16	254 / 82252
18	254 / 82253
20	254 / 82254

**MATERIALS:** Flange is made of polypropylene black colour.

**FEATURES:** To be assembled to our roller for chain return Part.251, 252, 253, 245, 293, 250, 249.

**BOX QUANTITY:** 96 pieces.

**ON REQUEST:**

- **Flanges:** Special bores, other colours.
- **Box Quantity:** According to your request.

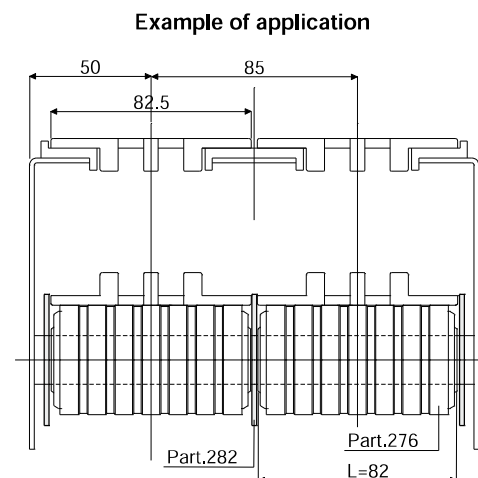

## Flange for chain guide (for Part. 276, 271, 270)

Part. **282**

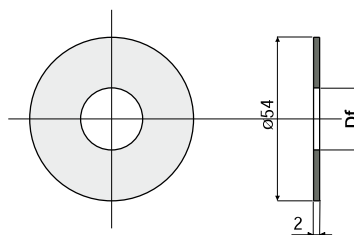

Df Bore for pin of (mm)	Code
15	282 / 82154
16	282 / 82155
18	282 / 82156
20	282 / 82157

**MATERIALS:** Flange is made of polypropylene black colour.

**FEATURES:** To be assembled to our roller for chain return Part.276, 271, 270.

**BOX QUANTITY:** 96 pieces.

**ON REQUEST:**

- **Flanges:** Special bores, other colours.
- **Box Quantity:** According to your request.